

**Environment and Natural Resources Trust Fund
2020 Request for Proposals (RFP)**

Project Title:

ENRTF ID: 280-G

Birch Lake Recreation Area Campground

Category: G. Land Acquisition for Habitat and Recreation

Sub-Category:

Total Project Budget: \$ 350,000

Proposed Project Time Period for the Funding Requested: June 30, 2023 (3 yrs)

Summary:

This project consists of expanding the existing Birch Lake Recreation Area to add a new 22 acre campground that will include 49 campsites for recreational vehicles and tent campers.

Name: Cathy Bissonette

Sponsoring Organization: City of Babbitt

Job Title: Clerk-Treasurer

Department:

Address: 71 South Drive

Babbitt MN 55706

Telephone Number: (218) 827-3647

Email cathy@babbitt-mn.com

Web Address:

Location:

Region: Northeast

County Name: St. Louis

City / Township: Babbitt

Alternate Text for Visual:

The visual shows the new campground layout.

_____ Funding Priorities	_____ Multiple Benefits	_____ Outcomes	_____ Knowledge Base
_____ Extent of Impact	_____ Innovation	_____ Scientific/Tech Basis	_____ Urgency
_____ Capacity	_____ Readiness	_____ Leverage	_____ TOTAL _____%



Environment and Natural Resources Trust Fund (ENRTF)
2020 Main Proposal Template

PROJECT TITLE: Birch Lake Recreation Area Campground

I. PROJECT STATEMENT

This project consists of expanding the existing Birch Lake Recreation Area to add a new 22 acre campground that will include 49 new campsites that will accommodate recreational vehicles as well as tent campers. Two restrooms and a camp office/shower/restroom facility will be constructed at the campground to serve campers. City utilities (water, sewer, electrical) will be extended to the campground and to the existing facilities in the recreation area. The extension of this infrastructure will also open up areas for new commercial and housing development. The Birch Lake Recreation Area sits on a 37 acre, city owned parcel located on Birch Lake. The campground will be connected to an existing paved pedestrian/bike trail that connects to the City of Babbitt and eventually to the Mesabi Trail. The campground will also connect to the new Prospector ATV trail that will serve campers looking for off trail vehicle opportunities. The City of Babbitt and the surrounded area are very limited in camping sites and the existing sites are always filled.

The existing recreation area has a beach house equipped with changing rooms, restrooms, life guard/first aid room and a concession stand. The beach area has two rafts, a water slide, a picnic area with shelters, outdoor grills, a fully equipped playground area with activities for all ages and area lighting.

The City of Babbitt has completed a total reconstruction of the boat landing area along Birch Lake. The area includes a new parking area with handicapped parking, two new docks, a new concrete boat landing ramp, a boat cleaning area and a rain garden for storm water runoff.

The Birch Lake Recreation Area is located on the shores of Birch Lake. Birch Lake is a 7,000 acre lake that is one of the most heavily fished lakes in the Tower Fisheries Management Area. The lake is 75% undeveloped and provides a BWCA experience. The BWCA is only two portages away from Birch Lake.

Birch Lake and the Birch Lake Recreation Area serves numerous tourists from all over Minnesota, the U.S. and Canada.

The total estimated cost of this project is \$4,300,000. The City of Babbitt is requesting \$350,000 from the 2020 ENRTF and has submitted applications to the IRRRB, State Bonding Bill and Greater MN Regional Parks and Trails Commission (See Budget Page). The City of Babbitt is recommended for \$350,000 from the 2019 ENRTF and is requesting additional funds of \$350,000 (balance of the 2019 ENRTF request) this year to make the project economically feasible for the City.

II. PROJECT ACTIVITIES AND OUTCOMES

Activity 1 Title: Construction Administration

Description: *Material Testing, Staking, Inspection and construction administration.*

ENRTF BUDGET: \$150,000

Outcome	Completion Date
1. Matching Funds Secured	



Environment and Natural Resources Trust Fund (ENRTF)
2020 Main Proposal Template

2. <i>Materials Testing/Staking</i>	<i>November 2020</i>
3. <i>Construction Administration</i>	<i>December 2022</i>

Activity 2 Title: Project Construction

Description: *Construction of the Campground Sites, Campground Buildings, Campground Infrastructure.*

ENRTF BUDGET: \$200,000

Outcome	Completion Date
1. <i>Project Bid</i>	<i>February 2020</i>
2. <i>Construction Start</i>	<i>August 2020</i>
3. <i>Construction Completed</i>	<i>December 2022</i>

III. PROJECT PARTNERS AND COLLABORATORS:

City of Babbitt Mayor and Council
City of Babbitt Staff
Prospector ATV Club
Mesabi Trail
IRRRB
Campground Operator
Consulting Engineer
General Contractor

IV. LONG-TERM IMPLEMENTATION AND FUNDING:

The long-term implementation consists of constructing a new campground at the Birch Lake Recreation Area in Babbitt that will provide a high quality nature and recreation experience for people of all ages. The campground will be open to the general public and will be open annually from May – September. The campground will provide a variety of activities including water recreation, access to non-motorized trails, access to an ATV trail system and tent and RV camping sites. The future funding for the maintenance and/or expansions of the campground will be provided by the City of Babbitt through their annual budget and through campground user fees. The City of Babbitt has been recommended for funds from the State Bonding Bill, LCCMR and the IRRRB. Any revenue generated from the campground will be reinvested in the campground.

Attachment A: Project Budget Spreadsheet
 Environment and Natural Resources Trust Fund
 M.L. 2020 Budget Spreadsheet

Legal Citation:

Project Manager: Cathy Bissonette

Project Title: Clerk-Treasurer

Organization: City of Babbitt

Project Budget: \$350,000

Project Length and Completion Date: 3 years - December 2023

Today's Date: March 13, 2019



ENVIRONMENT AND NATURAL RESOURCES TRUST FUND BUDGET		Budget	Amount Spent	Balance
BUDGET ITEM				
Material Testing/Staking/Inspection/Construction Management		\$ 150,000	\$ -	\$ 150,000
Project Construction		\$ 200,000	\$ -	\$ 200,000
A competitive bidding process will be used.				
		\$ -	\$ -	\$ -
		\$ -	\$ -	\$ -
		\$ -	\$ -	\$ -
		\$ -	\$ -	\$ -
		\$ -	\$ -	\$ -
		\$ -	\$ -	\$ -
		\$ -	\$ -	\$ -
		\$ -	\$ -	\$ -
COLUMN TOTAL		\$ 350,000	\$ -	\$ 350,000
SOURCE AND USE OF OTHER FUNDS CONTRIBUTED TO THE PROJECT	Status (secured or pending)	Budget	Spent	Balance
Non-State: IRRRB	Secured	\$ 250,000	\$ -	\$ 250,000
Non-State: IRRRB	Pending	\$ 250,000	\$ -	\$ 250,000
State: Bonding Bill 2018 for Planning & Construction Match	Secured	\$ 1,300,000	\$ -	\$ 1,300,000
State: Bonding Bill 2019 for Planning & Construction Match	Pending	\$ 750,000	\$ -	\$ 750,000
In kind: City Bonding	Secured	\$ 1,050,000	\$ -	\$ 1,050,000
Other ENRTF APPROPRIATIONS AWARDED IN THE LAST SIX YEARS	Amount legally obligated but not yet spent	Budget	Spent	Balance
M. L. 2019 Birch Lake Recreation Area Campground (Recommended)	\$ 350,000	\$ 350,000	\$ -	\$ 350,000

Save: 3/1/2018 4:54 PM thompson Plot: 3/1/2018 4:54 PM P:\VEI\BABB\144900\5-final-dgn\51-drawings\10-Civil\cad\dwg\sheet\100 BX11 Exhibit.dwg

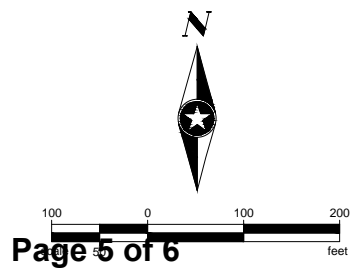
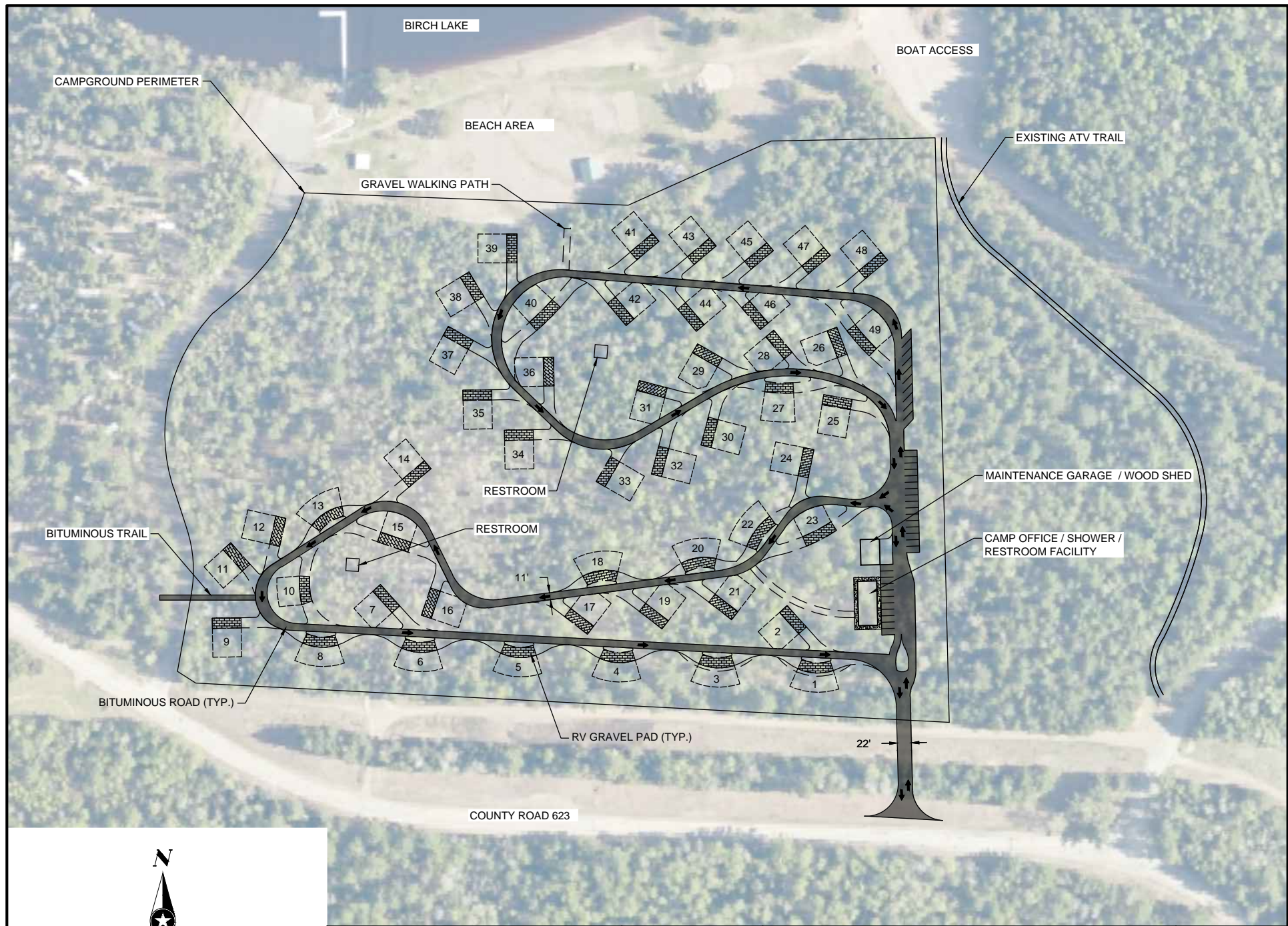

PHONE: 218.741.4284
615 9TH STREET NORTH
VIRGINIA, MN 55792-3761
www.sehinc.com

05/12/2019

FILE NO.
BABB 144900

DATE:
03/02/2018

CONCEPT LAYOUT
BIRCH LAKE CAMPGROUND
BABBITT, MN

ENRTF ID: 280-G

EXHIBIT
NO. 1

PROJECT TITLE: Birch Lake Recreation Area Campground

Project Manager Qualifications and Organization Description

Project Manager Qualifications

The overall manager for this project will be the City of Babbitt under the direction of the Mayor/City Council and City Staff. Additional project management and over-site will come from the consulting engineer. Cathy Bissonette (City Clerk-Treasurer), Joe Scherer (Parks and Rec Director) and the city park committee have been overseeing the development of this project since its initial inception and have many years of experience in overseeing large city construction projects.

Organization Description

Babbitt is a small community of 1500 residents located at the eastern end of the Mesabi Iron Range near Birch Lake in Northeastern Minnesota. Babbitt lies approximately 100 miles north from the City of Duluth. The vast majority of the land surrounding the City of Babbitt is comprised of forested land, unique geological formations, and abundant water resources which provide much of the scenic beauty of the area.

Only two portages from the BWCA, its location offers a unique combination of access to outdoor activities and cultural and business opportunities. Outdoor amenities in Babbitt include beaches, little league fields, softball fields, parks, golf course, fishing piers, youth center and an ice arena. The area also offers excellent opportunities for viewing or photographing wildlife such as wolves, moose, deer, bear and a wide variety of birds.

The economy of Babbitt has been built around the traditional resource-based industries of taconite, timber, tourism and transportation. As the case with all economies heavily dependent on resources, Babbitt has experienced cycles of boom and bust.

The City of Babbitt is governed by a Mayor and four council members. Their staff includes a clerk-treasurer, deputy clerk-treasurer, fire chief, library director, parks and recreation director, planning and zoning officer, police chief, public utilities superintendent, street supervisor, ambulance superintendent, assessor, attorney and auditor.