

**Environment and Natural Resources Trust Fund  
2019 Request for Proposals (RFP)**

---

**Project Title:**

**ENRTF ID: 264-G**

Birch Lake Recreation Area Campground

---

**Category:** G. Land Acquisition for Habitat and Recreation

**Sub-Category:**

---

**Total Project Budget: \$** 700,000

**Proposed Project Time Period for the Funding Requested:** June 30, 2022 (3 yrs)

**Summary:**

This project consists of expanding the existing Birch Lake Recreation Area to add a new 22 acre campground that will include 49 campsites for recreational vehicles and tent campers.

---

**Name:** Cathy Bissonette

**Sponsoring Organization:** City of Babbitt

**Title:** City Clerk-Treasurer

**Department:**

**Address:** 71 South Drive

Babbitt MN 55706

**Telephone Number:** (218) 827-3646

**Email** cathy@babbitt-mn.com

**Web Address**

---

**Location**

**Region:** Northeast

**County Name:** St. Louis

**City / Township:** Babbitt

---

**Alternate Text for Visual:**

The visual shows the new campground layout.

_____ Funding Priorities	_____ Multiple Benefits	_____ Outcomes	_____ Knowledge Base
_____ Extent of Impact	_____ Innovation	_____ Scientific/Tech Basis	_____ Urgency
_____ Capacity	_____ Readiness	_____ Leverage	_____ TOTAL _____%
_____ If under \$200,000, waive presentation?			



## Environment and Natural Resources Trust Fund (ENRTF) 2019 Main Proposal

### PROJECT TITLE: Birch Lake Recreation Area Campground

#### I. PROJECT STATEMENT

This project consists of expanding the existing Birch Lake Recreation Area to add a new 22 acre campground that will include 49 new campsites that will accommodate recreational vehicles as well as tent campers. Two restrooms and a camp office/shower/restroom facility will be constructed at the campground to serve campers. City utilities (water, sewer, electrical) will be extended to the campground and to the existing facilities in the recreation area. The extension of this infrastructure will also open up areas for new commercial and housing development. The Birch Lake Recreation Area sits on a 37 acre, city owned parcel located on Birch Lake. The campground will be connected to an existing paved pedestrian/bike trail that connects to the City of Babbitt and eventually to the Mesabi Trail. The campground will also connect to the new Prospector ATV trail that will serve campers looking for off trail vehicle opportunities. The City of Babbitt and the surrounded area are very limited in camping sites and the existing sites are always filled.

The existing recreation area has a beach house equipped with changing rooms, restrooms, life guard/first aid room and a concession stand. The beach area has two rafts, a water slide, a picnic area with shelters, outdoor grills, a fully, equipped playground area with activities for all ages and area lighting.

The City of Babbitt has completed a total reconstruction of the boat landing area along Birch Lake. The area includes a new parking area with handicapped parking, two new docks, a new concrete boat landing ramp, a boat cleaning area and a rain garden for storm water runoff.

The Birch Lake Recreation Area is located on the shores of Birch Lake. Birch Lake is a 7,000 acre lake that is one of the most heavily fished lakes in the Tower Fisheries Management Area. The lake is 75% undeveloped and provides a BWCA experience. The BWCA is only two portages away from Birch Lake.

Birch Lake and the Birch Lake Recreation Area serves numerous tourists from all over Minnesota, the U.S. and Canada.

The total estimated cost of this project is \$4,300,000. The City of Babbitt is requesting \$700,000 from the ENRTF and has submitted applications to the IRRRB, State Bonding Bill and Greater MN Regional Parks and Trails Commission (See Budget Page).

#### II. PROJECT ACTIVITIES AND OUTCOMES

**Activity 1:** Project Engineering, Design, Staking and Construction Administration for the Campground Sites/Campground Buildings/ Municipal Utilities

#### ENRTF BUDGET: \$200,000

Outcome	Completion Date
1. Completion of Plans and Specifications	August 2019
2. Final Design Review	September 2019
3. Completion of Bidding Documents	November 2019



**Environment and Natural Resources Trust Fund (ENRTF)  
2019 Main Proposal**

**Activity 2: Project Construction of the Campground Sites/Campground Buildings/ Municipal Utilities**

**ENRTF BUDGET: \$500,000**

<b>Outcome</b>	<b>Completion Date</b>
<i>1. Project Bid</i>	<i>February 2020</i>
<i>2. Construction Commencement</i>	<i>May 2020</i>
<i>3. Construction Completed</i>	<i>December 2020</i>

**III. PROJECT PARTNERS:**

**Partners receiving ENRTF funding**

Consulting Engineer – Role: Project Design/Construction Administration/Project Management

General Contractor – Role: Project Construction – Hired Through Competitive Bidding Process

**Partners NOT receiving ENRTF funding**

City Mayor and Clerk – Role: Project Administration

City Parks and Recreation Director – Role: Park Maintenance

City Campground Manager – Role: Park Operations

City Campground Committee – Role: Park Planning and Funding

**IV. LONG-TERM- IMPLEMENTATION AND FUNDING:**

The long-term implementation consists of constructing a new campground at the Birch Lake Recreation Area in Babbitt that will provide a high quality nature and recreation experience for people of all ages. The campground will be open to the general public and will be open annually from May – September. The campground will provide a variety of activities including water recreation, access to non-motorized trails, access to an ATV trail system and tent and RV camping sites. The future funding for the maintenance and/or expansions of the campground will be provided by the City of Babbitt through their annual budget and through campground user fees.

**V. TIME LINE REQUIREMENTS:**

This project will be completed as proposed in the project activities section of this application.

## 2019 Proposal Budget Spreadsheet

**Project Title:** Birch Lake Recreation Area Campground

### IV. TOTAL ENRTF REQUEST BUDGET [3] years

BUDGET ITEM	AMOUNT
Project Engineering/Design/Construction Administration for the utility extensions and campground construction. Work will be performed by a licensed, professional engineering firm	\$200,000
Project Construction of the campground and utility extensions. General Contractor to be hired through a competitive bidding process.	\$500,000
	\$ -
	\$ -
	\$ -
	\$ -
<b>TOTAL ENVIRONMENT AND NATURAL RESOURCES TRUST FUND \$ REQUEST =</b>	<b>\$ 700,000</b>

### V. OTHER FUNDS

SOURCE OF FUNDS	AMOUNT	Status
Other Non-State \$ To Be Applied To Project During Project Period: City of Babbitt	\$800,000	Secured
Other Non-State \$ To Be Applied To Project During Project Period: IRRRB	\$500,000	Pending
Other State \$ To Be Applied To Project During Project Period: State Bonding Bill	\$1,300,000	Pending
Other State \$ To Be Applied To Project During Project Period: Greater MN Parks and Trails	\$1,000,000	Pending
In-kind Services To Be Applied To Project During Project Period:	NA	NA
Past and Current ENRTF Appropriation:	NA	NA
Other Funding History:	NA	NA



Save: 3/1/2018 4:54 PM thompson Plot: 3/1/2018 4:54 PM P:\VE\B\BABB\144900\5-final-dgn\51-drawings\10-Civil\cad\dwg\sheet\100 BX11 Exhibit.dwg

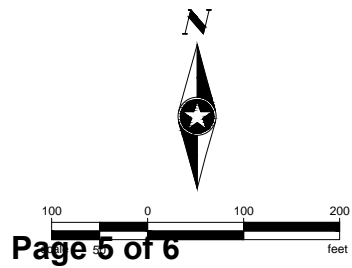
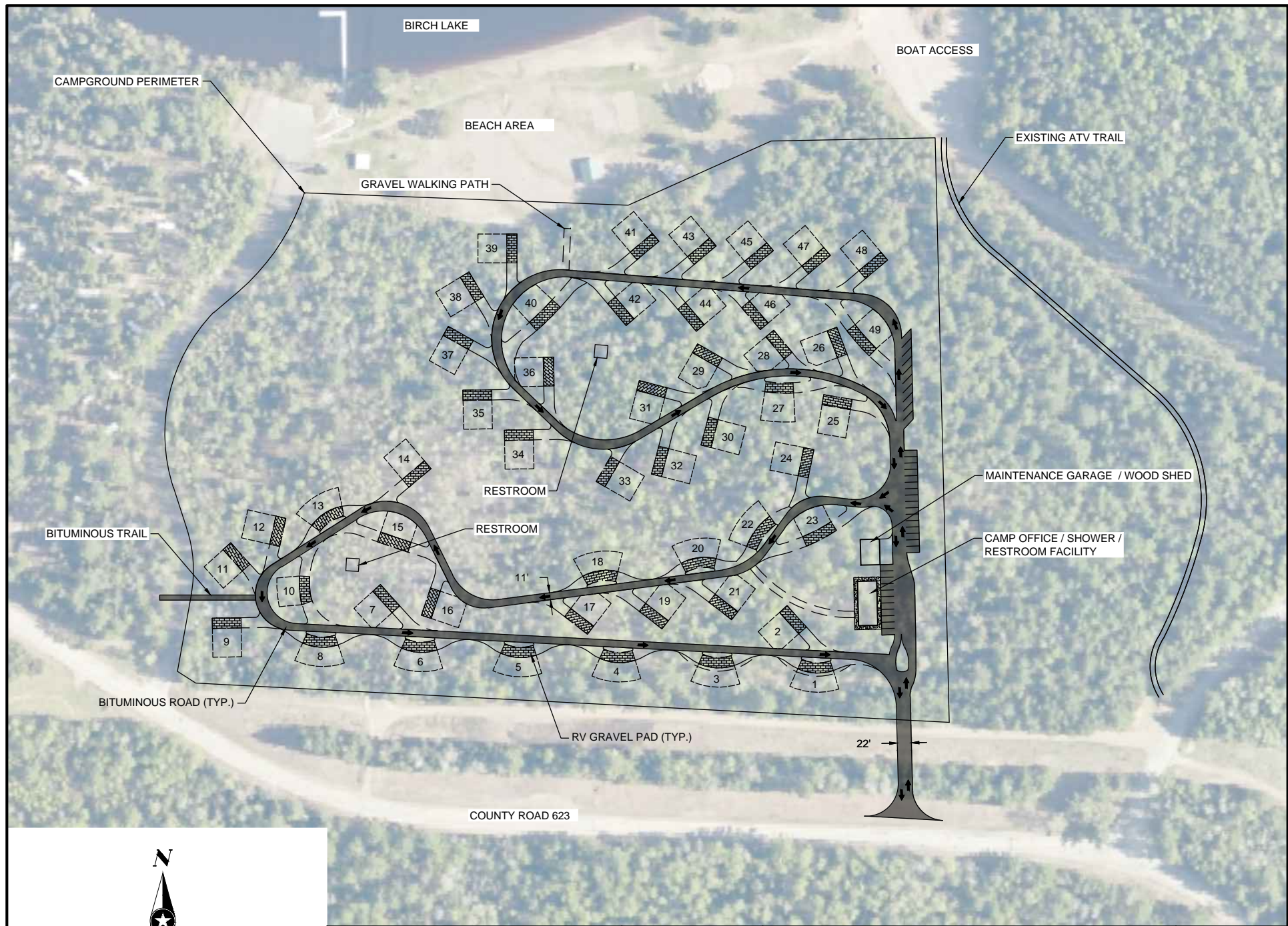

PHONE: 218.741.4284  
615 9TH STREET NORTH  
VIRGINIA, MN 55792-3761  
www.sehinc.com

05/08/2018

FILE NO.  
BABB 144900

DATE:  
03/02/2018

CONCEPT LAYOUT  
BIRCH LAKE CAMPGROUND  
BABBITT, MN  
ENTRF ID: 264-G

EXHIBIT  
NO. 1

## **PROJECT TITLE: Birch Lake Recreation Area Campground**

### **Project Manager Qualifications and Organization Description**

#### **Project Manager Qualifications**

The overall manager for this project will be the City of Babbitt under the direction of the Mayor/City Council and City Staff. Additional project management and over-site will come from the consulting engineer. Cathy Bissonette (City Clerk-Treasurer), Joe Scherer (Parks and Rec Director) and Rich Posey (Street Supervisor) and the city park committee have been overseeing the development of this project since its initial inception and have many years of experience in overseeing large city construction projects.

#### **Organization Description**

Babbitt is a small community of 1500 residents located at the eastern end of the Mesabi Iron Range near Birch Lake in Northeastern Minnesota. Babbitt lies approximately 100 miles north from the City of Duluth. The vast majority of the land surrounding the City of Babbitt is comprised of forested land, unique geological formations, and abundant water resources which provide much of the scenic beauty of the area.

Only two portages from the BWCA, its location offers a unique combination of access to outdoor activities and cultural and business opportunities. Outdoor amenities in Babbitt include beaches, little league fields, softball fields, parks, golf course, fishing piers, youth center and an ice arena. The area also offers excellent opportunities for viewing or photographing wildlife such as wolves, moose, deer, bear and a wide variety of birds.

The economy of Babbitt has been built around the traditional resource-based industries of taconite, timber, tourism and transportation. As the case with all economies heavily dependent on resources, Babbitt has experienced cycles of boom and bust.

The City of Babbitt is governed by a Mayor and four council members. Their staff includes a clerk-treasurer, deputy clerk-treasurer, fire chief, library director, parks and recreation director, planning and zoning officer, police chief, public utilities superintendent, street supervisor, ambulance superintendent, assessor, attorney and auditor.