

**Environment and Natural Resources Trust Fund
2016 Request for Proposals (RFP)**

Project Title:

ENRTF ID: 184-G

Babbitt Recreation Area Water Protection Project

Category: G. Land Acquisition for Habitat and Recreation

Total Project Budget: \$ 623,000

Proposed Project Time Period for the Funding Requested: 2 years, July 2016 to June 2018

Summary:

This project will prevent drainage flow along the entrance road and parking area and to construct a rain garden to prevent debris, sediment and pollution from entering Birch Lake.

Name: Cathy Bissonette

Sponsoring Organization: City of Babbitt

Address: 71 South Drive
Babbitt MN 55706

Telephone Number: (218) 827-3647

Email cathy@babbitt-mn.com

Web Address www.babbitt-mn.com

Location

Region: NE

County Name: St. Louis

City / Township: Babbitt

Alternate Text for Visual:

Lay-out of the improvements to prevent pollution from entering Birch Lake.

_____ Funding Priorities	_____ Multiple Benefits	_____ Outcomes	_____ Knowledge Base
_____ Extent of Impact	_____ Innovation	_____ Scientific/Tech Basis	_____ Urgency
_____ Capacity Readiness	_____ Leverage	_____ TOTAL	_____ %



PROJECT TITLE: Babbitt Recreation Area Water Protection Project

I. PROJECT STATEMENT

Babbitt has completed a preliminary hydrologic analysis to gain an understanding of existing and proposed hydrologic conditions of Birch Lake at the Babbitt Recreation Area. The area is currently experiencing environmental issues due to erosion of the roadside ditches, which causes sediment, debris, and pollution associated with parking lot areas to flow directly into lake, as well as causing erosion of the bituminous area near the lake access.

In order to correct this problem, the drainage within the roadside ditches will need to be slowed down. This will be accomplished by installing a series of rock checks to be placed every 50 feet (13 total on each side of the road). These rock checks, 6-inches in height and spanning the width of the ditch, will help with roadside scour that is currently causing erosion leading to sediment and debris transport. These ditch checks will also enhance the infiltration occurring in the road ditches and reduce the runoff volume that will reach the parking lot/boat landing area.

To prevent drainage from sheet flowing across the boat landing/ parking lot directly into the lake, drainage from the roadside ditches will be captured by a storm sewer system. This system will be installed to carry drainage to the proposed rain garden located on the east side of the proposed parking lot and boat landing. The proposed parking lot/boat landing will be resurfaced and sloped slightly to the east so any additional drainage will be captured by the rain garden prior to entering the lake at the boat landing area.

The proposed rain garden will have an overflow structure piped to the lake and away from the parking lot/ boat landing area to reduce erosion of the lake bank. For the larger and more infrequent storm events, there will be an emergency overflow 1-foot from the top of the rain garden, to divert water towards the lake.

The City of Babbitt will also be working in cooperation with the MN DNR to completely replace the existing boat landing and docks.

II. PROJECT ACTIVITIES AND OUTCOMES

Activity 1: *Project Design, Engineering and Construction Administration*

Budget: \$89,000

Outcome	Completion Date
<i>1. Completion of Plans and Specifications</i>	<i>August 2016</i>
<i>2. Final Design Review and Completion</i>	<i>September 2016</i>
<i>3. Bidding Documents Complete</i>	<i>November 2016</i>
<i>Etc.</i>	



PROJECT TITLE: Babbitt Recreation Area Water Protection Project

Activity 2: Project Construction

Budget: \$569,000

Outcome	Completion Date
<i>1. Project Bid</i>	<i>May 2017</i>
<i>2. Construction Commencement</i>	<i>June 2017</i>
<i>3. Construction Completion</i>	<i>September 2017</i>
<i>Etc.</i>	

III. PROJECT STRATEGY

A. Project Team/Partners

City of Babbitt – Project Owners and Project Managers
 MN DNR – Boat Landing Construction
 Consultants as needed for design, construction administration and project management.

B. Project Impact and Long-Term Strategy

The impact of this project once completed will be to dramatically reduce the pollution, sediments and debris currently entering into Birch Lake. The long term strategy is to maintain the project to improve the water quality of the lake so it is available for use by future generations.

Birch Lake is a 7,074-acre lake located between Ely and Babbitt in northeast Minnesota. The lake is one of the more heavily fished lakes of the Tower Fisheries Management Area. It is convenient to both Ely and Babbitt and has several good public accesses with concrete plank boat ramps around the lake. Shoreline development on the lake has increased considerably in recent years, however 75% of the shoreline is undeveloped and under public ownership. On Birch Lake, anglers have had success catching walleye, northern pike, black crappie, and bluegill.

C. Timeline Requirements

The project will be completed as proposed in the project activities section.

2016 Detailed Project Budget

Project Title: Babbitt Recreation Area Water Protection Project

IV. TOTAL ENRTF REQUEST BUDGET 2 years

<u>BUDGET ITEM</u>	<u>AMOUNT</u>
Personnel:	\$ -
Professional/Technical/Service Contracts: <i>Project Engineering Design/Construction Administration- Work will be performed by a licensed, professional engineering firm.</i>	\$89,000
Construction: General Contractor to be hired through a competitive bidding process.	\$534,000
Acquisition (Fee Title or Permanent Easements):	\$ -
Travel:	\$ -
Additional Budget Items:	\$ -
TOTAL ENVIRONMENT AND NATURAL RESOURCES TRUST FUND \$ REQUEST =	\$ 623,000

V. OTHER FUNDS

<u>SOURCE OF FUNDS</u>	<u>AMOUNT</u>	<u>Status</u>
Other Non-State \$ To Be Applied To Project During Project Period: <i>City of Babbitt</i>	\$25,000	<i>Secured</i>
Other State \$ To Be Applied To Project During Project Period: <i>N/A</i>	\$ -	
In-kind Services To Be Applied To Project During Project Period: <i>MN DNR - Boat Landing</i>	\$10,000	<i>Secured</i>
Funding History: <i>N/A</i>	\$ -	
Remaining \$ From Current ENRTF Appropriation: <i>N/A</i>	\$ -	

**PROJECT TITLE: BABBITT
RECREATION AREA WATER
PROTECTION PROJECT**

APPROXIMATE WATER LEVEL

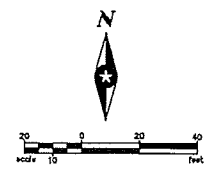
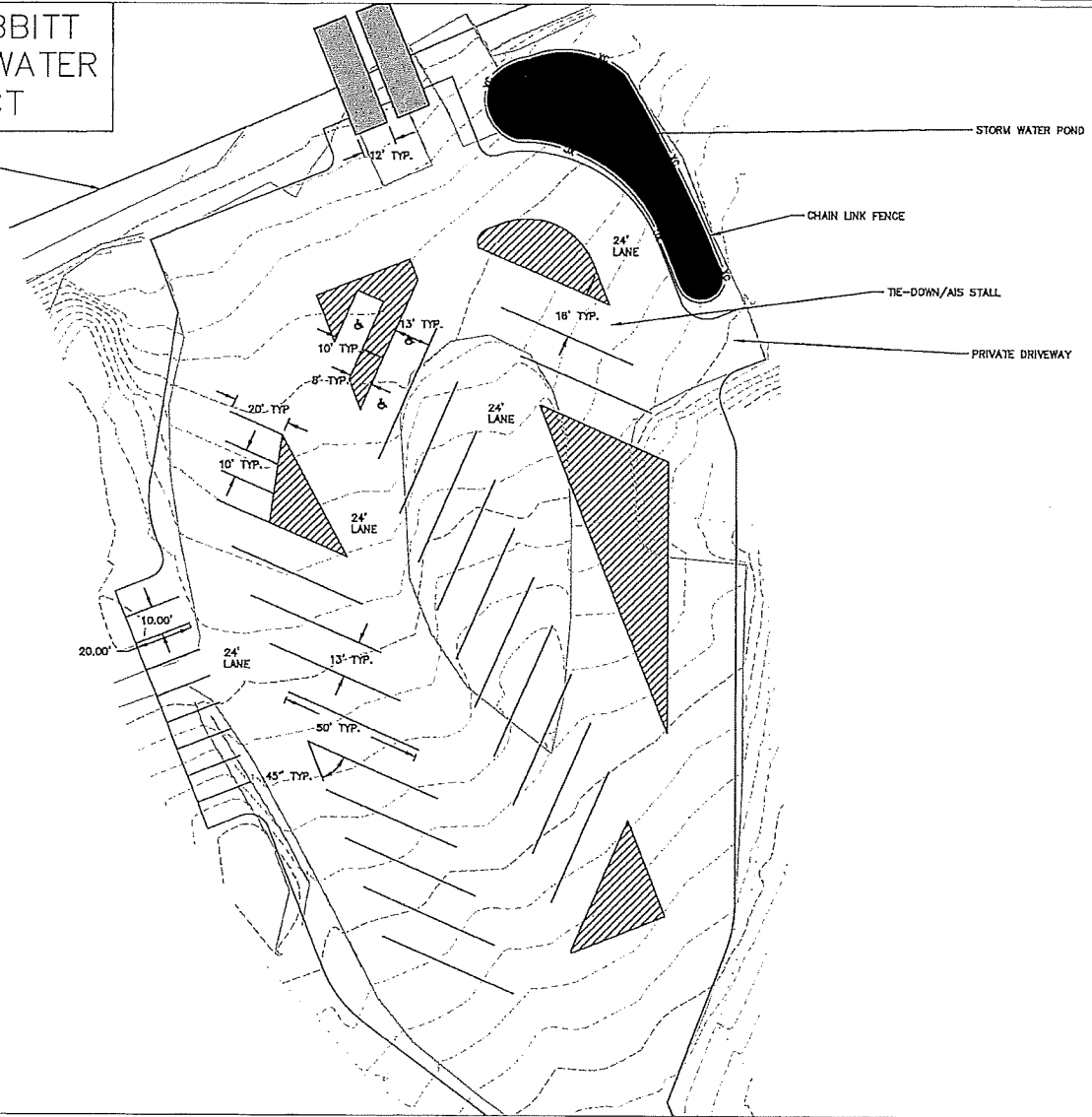

PARKING SUMMARY
 -22 VEHICLE/TRAILER 13'X50'
 -13 SINGLE VEHICLE 10'X20'
 -1 TIE DOWN/AIS STALL 18'X50'

P:\V\B\BABBITT\BABBITT.dwg - Plot - 07/14/15 10:05:00 AM

 PHONE: 218.741.4284 813 W. 57th St VIRGINIA, MN 55792-3761 www.sehinc.com	BIRCH LAKE BOAT LANDING	CONCEPTUAL DRAWING	FILE NO. BABB1131627	1
	BABBITT, MINNESOTA		2	

PROJECT TITLE: Babbitt Recreation Area Water Protection Project

Project Manager Qualifications and Organization Description

Project Manager Qualifications

The overall manager for this project will be the City of Babbitt under the direction of the City Council and City Staff. Additional project management and over-site will come from the consulting engineer. City Clerk/Treasurer Cathy Bissonette and Rich Posey, street supervisor have been overseeing the development of this project since its initial inception and have many years of experience in overseeing large city construction projects.

Organization Description

Babbitt is a small community of 1600 residents located at the eastern end of the legendary Mesabi Iron Mining Range near Birch Lake in Northeast Minnesota. Only two portages from the BWCA, its location offers a unique combination of access to outdoor activities and cultural and business opportunities.

Outdoor activities include excellent fishing on Birch Lake with a range of resort or camping facilities available. The area also offers excellent opportunities for viewing or photographing wildlife such as wolves, moose, deer, bear and smaller game.